



Vaucluse

The Vaucluse is one of our most popular Homestead style homes suited to a rural residential block with plenty of frontage. The open plan living areas are designed to capture rear facing northerly or easterly views and all the winter sunshine. The home is very functional and has a bonus of 4th bedroom or study. A great economical family home for those on a budget.

Specifications

Internal:	162.6m ²
Garage:	40.4m ²
Porch:	3.4m ²
Alfresco:	10.29m ²
TOTAL AREA:	216.69m²

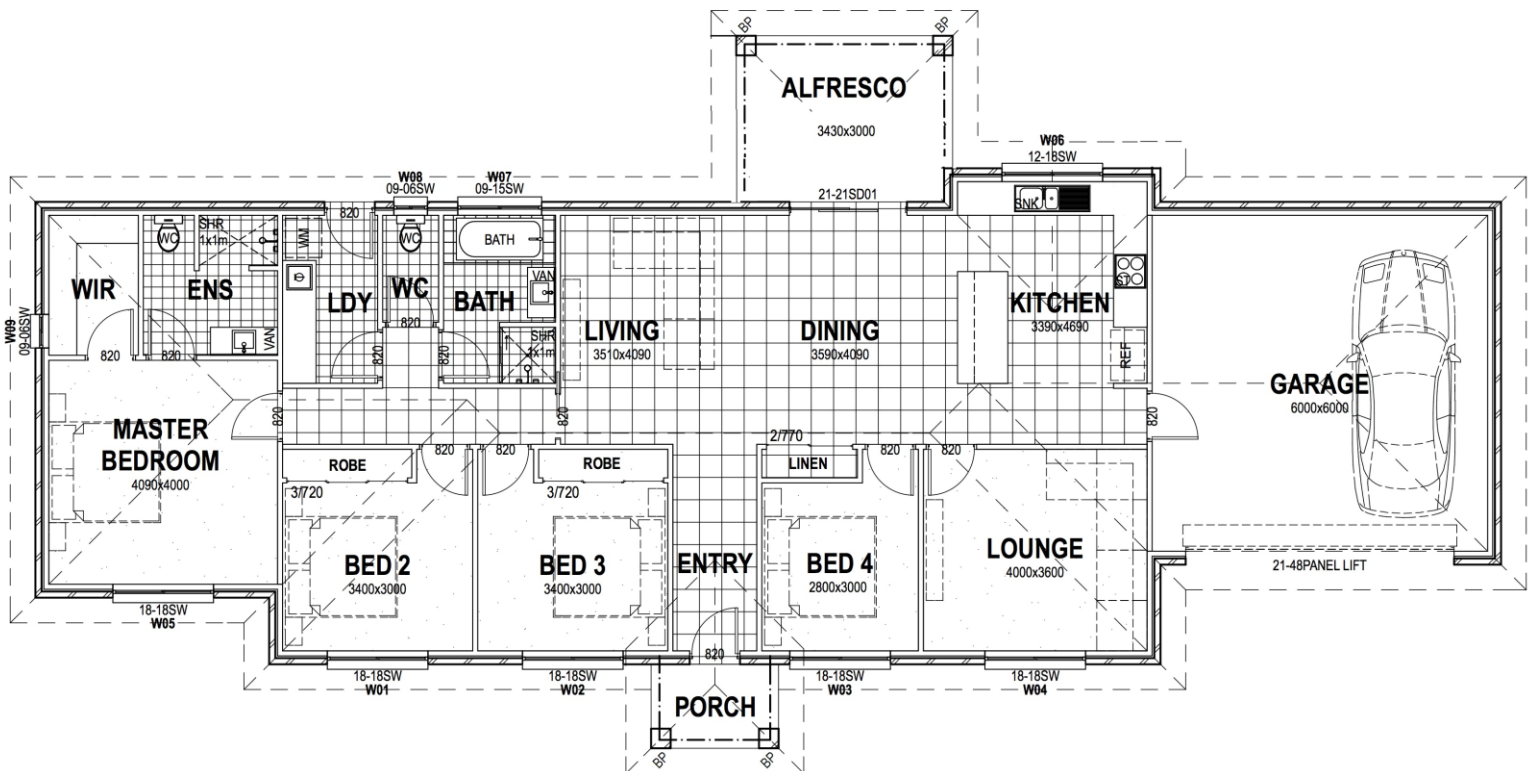

Your dream home at an affordable price

wjmhomes.com

(02) 6762 6860

wjmhomes@bigpond.com